

## Electric Pedestrian Pallet Stacker KMSac.4W 12xxxx TT

Type sheet for industrial Trucks according to **VDI 2198**

		Veni and Co Ltd			
		124416 TT	124920 TT	125727 TT	
Characteristics	1.1	Manufacturer			
	1.2	Model designation			
	1.3	Power unit	Battery		
	1.4	Operation	Pedestrian		
	1.5	Load capacity	<b>Q</b>	(kg) 1200	
	1.5.1	Residual capacity	<b>Qres</b>	-	
		$h_3+h_{13} = - / 4476^* / 3300^{**}$ mm	-	(kg) -	
		$h_3+h_{13} = 4476 / 4980^* / 5787^{**}$ mm	-	(kg) 1200    1050*    900**	
	1.6	Load center	c	(mm) 600	
1.8	Axle center to fork face	x	(mm) 760		
1.9	Wheel-base	y	(mm) 1445		
	2.1	Service weight	(kg)	1350    1380    1440	
Wheels/tyres	3.1	Tyres front/rear (Polyurethane/PU, Vulkollan/VU)	VU/VU		
	3.2	Tyre size, front (drive) wheel	(mm)	D 254x100	
	3.3	Tyre size, rear (load) wheel	(mm)	D 150x50 Twin	
	3.4	Suport wheel - 2 pcs.	(mm)	-	
	3.5	Wheels, number front (drive)/ rear (load) (x=driven)	(mm)	1x/4	
	3.6	Track width, front	$b_{10}$	(mm) -	
	3.7	Track width, rear	$b_{11}$	(mm) 1130-1530-1830	
Dimensions	4.2	Height, mast lowered	$h_1$	(mm) 2037    2205    2474	
	4.3	Free lift	$h_2$	(mm) 105	
	4.4	Lift	$h_3$	(mm) 4416    4920    5727	
	4.5	Height, mast extended	$h_4$	(mm) 4911    5415    6222	
	4.9	Height of tiller in drive position min/max	$h_{14}$	(mm) 1320/1500	
	4.10	Height of wheel arms	$h_8$	(mm) 280	
	4.15	Height lowered	$h_{13}$	(mm) 60	
	4.15.1	Height forks lifted	$h_3+h_{13}$	(mm) 4476    4980    5787	
	4.19	Overall length	$l_1$	(mm) 2082	
	4.20	Length to fork face	$l_2$	(mm) 882	
	4.21	Overall width front	$b_1$	(mm) 866	
		Overall width rear	$b_2$	(mm) 1395-1795-2095	
	4.22	Fork dimensions	s/e/l	(mm) 40/100/1200	
	4.23	Fork carriage ISO 2328	-	Class2B	
	4.24	Fork carriage width	$b_3$	(mm) 900-1300-1600	
	4.25	Overall forks width min/max	$b_5$	(mm) 300/860-1260-1560	
	4.26	Distance between wheel arms	$b_4$	(mm) 950-1350-1650	
4.31	Ground clearance, below mast	$m_1$	(mm) 60		
4.32	Ground clearance, center of wheelbase	$m_2$	(mm) 80		
4.34	Aisle width for pallets 800x1200mm along forks	Ast	(mm) -		
	Aisle width for pallets 800x1200mm across forks	Ast	(mm) -		
4.35	Turning radius	Wa	(mm) 1642		
4.37	Length across wheel arms	$l_7$	(mm) 1787		
Performance	5.1	Travel speed, with/without load	(km/h)	5.4/6.0	
	5.2	Lifting speed, with/without load	(m/s)	0.134/0.250	
	5.3	Lowering speed, with/without load	(m/s)	0.215/0.230	
	5.8	Maximum climbing ability, with/without load, rating 5 min	(%)	-	
	5.10	Service brake	Electromagnetic, regenerative		
Drive	6.1	Drive motor, rating S2 60 min	(kW)	2.9	
	6.2	Lift motor, rating S3 15%	(kW)	3.2	
	6.4	Battery voltage/rated capacity C5	(V/Ah)	24/270	
Other	8.1	Type of drive control	Pulse controller		
			COMBI AC/300A		

**KMSac.4W 12xxxx TT**

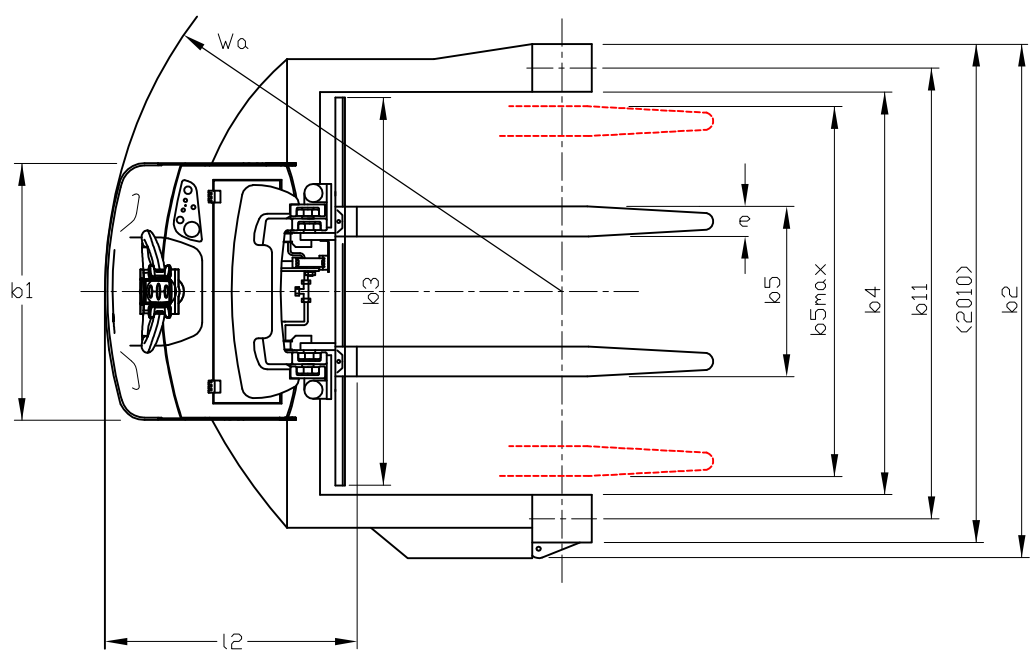
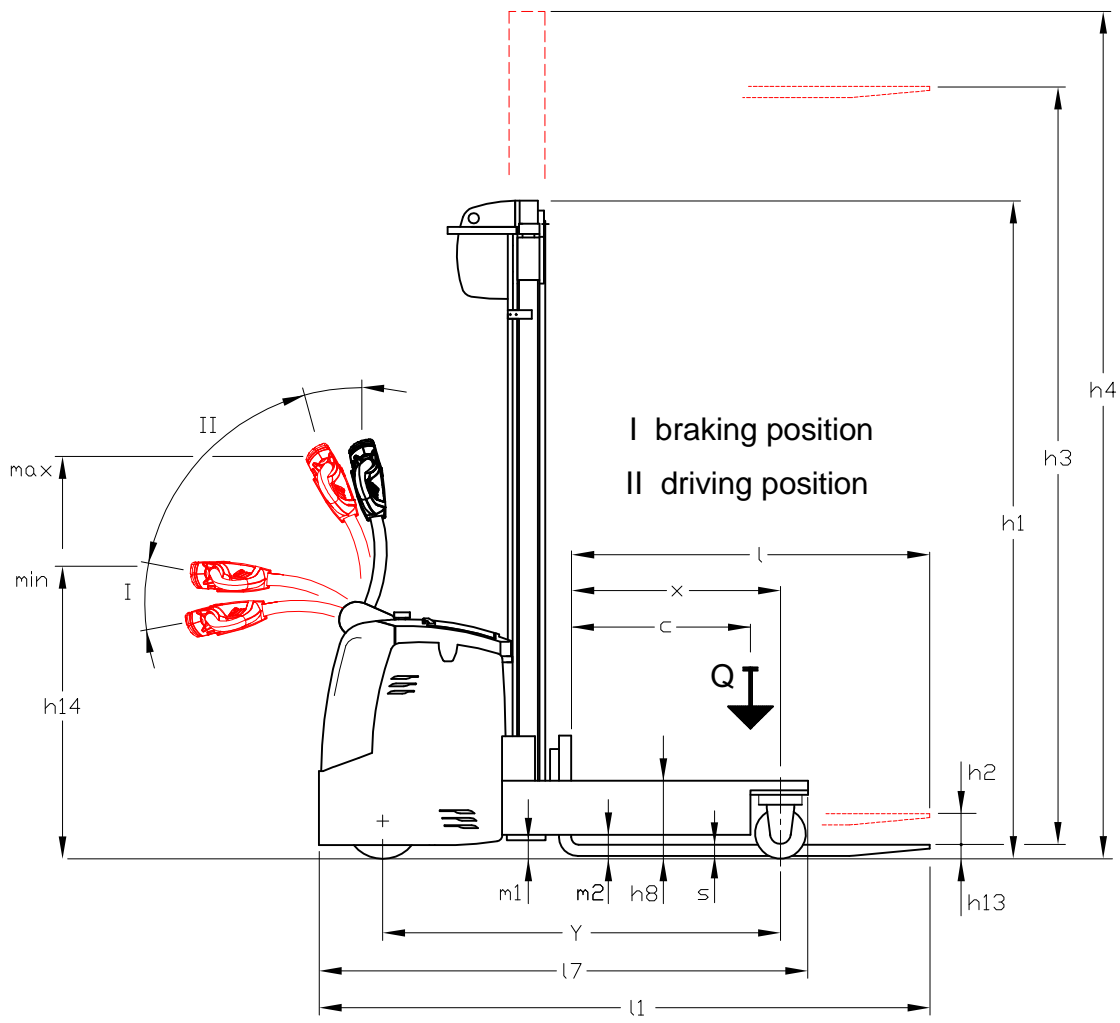

## Electric Pedestrian Pallet 4-way Stacker KMSac 12xxxx TT

### Standard equipment:

- Mid to Heavy-duty application
- Max. travel speed - 6,0 km/h
- Nominal capacity – 1200 kg
- **Modern AC technology** - for high speed, high torque, quiet and smooth running;
  - **AC Drive motor - 2,9 kW;**
  - **AC Steering motor - 0,4 kW.**
- **DC pump motor – 3,2 kW;**
- Electronics - modern **CANBUS-architecture** requiring less wiring, giving better reliability, providing easy and fast diagnostics;
- **Electric Powered progressive Steering;**
- Speed control by **Pulse controller COMBI AC/300A:**
  - smooth and gently running Forward/Backward;
  - smooth, step-less Lifting/Lowering;
  - regenerative braking with energy reclamation to the battery.
- Electronics - modern **CANBUS-architecture** requiring less wiring, giving better reliability, providing easy and fast diagnostics;
- Horn
- Automatic Braking:
  - **EMERGENCY** and **PARKING** electromagnetic brake
  - **REGENERATIVE** Braking when releasing Accelerator in a neutral position or reversing the travel direction
- Traction battery **24V 3PzS/270 Ah C5 / wet Pb Acid batteries:**
- High frequency/HF automatic on-board charger **24V/30A 1ph.:**
- **EMERGENCY** Switch
- Multifunction Digital Indicator displaying:
  - Battery's state of charge
  - Hour meter
  - Alarms
- **Proportional hydraulics for smooth, step less Lifting/Lowering speed control**
- **External Battery-charging Indicator;**
- Spring loaded Drive wheel;
- Traction wheel – VULKOLLAN tire 254x100mm;
- Support / Load wheels – VULKOLLAN tire;
- **CREEP SPEED** function – travelling in restricted areas with Tiller-arm in upright position
- Automatic Travel speed reduction when forks raised 1200 mm and more
- Robust Three-stage clear view mast / Triplex Telescopic
- Low-maintenance Drive-wheel unit:
  - Modern AC traction motor in vertical position
  - High efficient gear box /gears in oil bath - oil change required after 2000 working hours
  - High quality Traction wheel with VULKOLLAN, 93° Shore A tyre (other tyres available on request)
  - High quality Electromagnetic Brake with environment-friendly friction lining

### Specific standard equipment:

- **Chassis design – Straddle legs**
- **Distance between the wheel arms “b4=950mm” - Standard (1350 and 1650mm - Optional)**
- **Specific Load wheels;**
- **Fork carriage class 2B, ISO 2328, Carriage width “b3=900mm” - Standard (1300 and 1600 – Optional)**
- **Forged forks 40/100/1200mm, manually adjustable Overall forks width “b5= from 300 to 860” – Standard (1260 and 1560mm).**

### Optional Equipment

- |   |  |                |   |
|---|--|----------------|---|
| • Batteries with higher capacity:                   |  |                |   |
| - 315/375 Ah C5, incl. charger 24V/45A              |  | plus 233/377 € | - |
| • <b>Authorized access with PIN-Code management</b> |  | plus 174 €     | - |
| • <b>Full Free-lift mast</b>                        |  | plus 380 €     | - |
| • <b>Optional Straddle legs distance:</b>           |  |                |   |
| - “b4=1350mm”                                       |  | plus 186 €     | - |
| - “b4=1650mm”                                       |  | plus 247 €     | - |
| • Maintenance-free batteries                        |  | by request     | - |